

*Application does not view or function correctly on a smartphone. Please use a computer or tablet.

Never logged in to Parent Portal?

Your school provided you with an Activation Key when you registered your student. Use this key to create your user account. If you don't know your key, contact your school and the secretary can locate it for you. Once you have that key:

- If using the **Campus Parent** mobile app, open the app and search for your **District Name** and **State**.
 1. Click **New User?**
 2. Enter your **Activation Key** in the space provided and then **Submit**.
 3. Enter a **Username** and **Password** and click **Submit**.

- If using a web browser, visit <https://www.nebo.edu/> and from the Parents tab, select **Infinite Campus Parent Portal**.

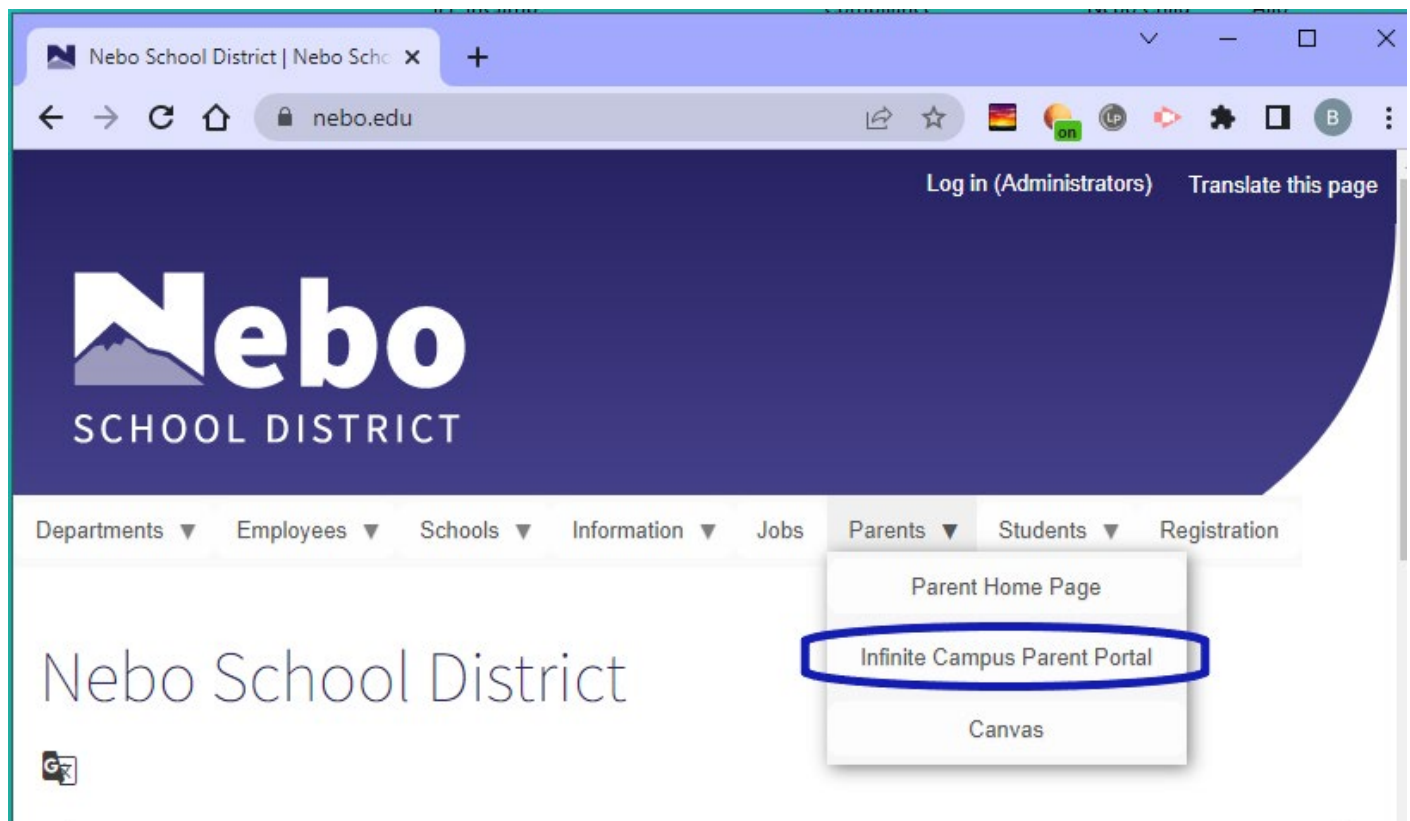

Login to your parent portal by entering your Parent Username and Password left of the screen and click **Login**

Campus provides displays in English, Spanish, and Chinese

****to change the display language of your portal **Before log in:** – scroll to the bottom and select ENGLISH or SPANISH from the dropdown box**

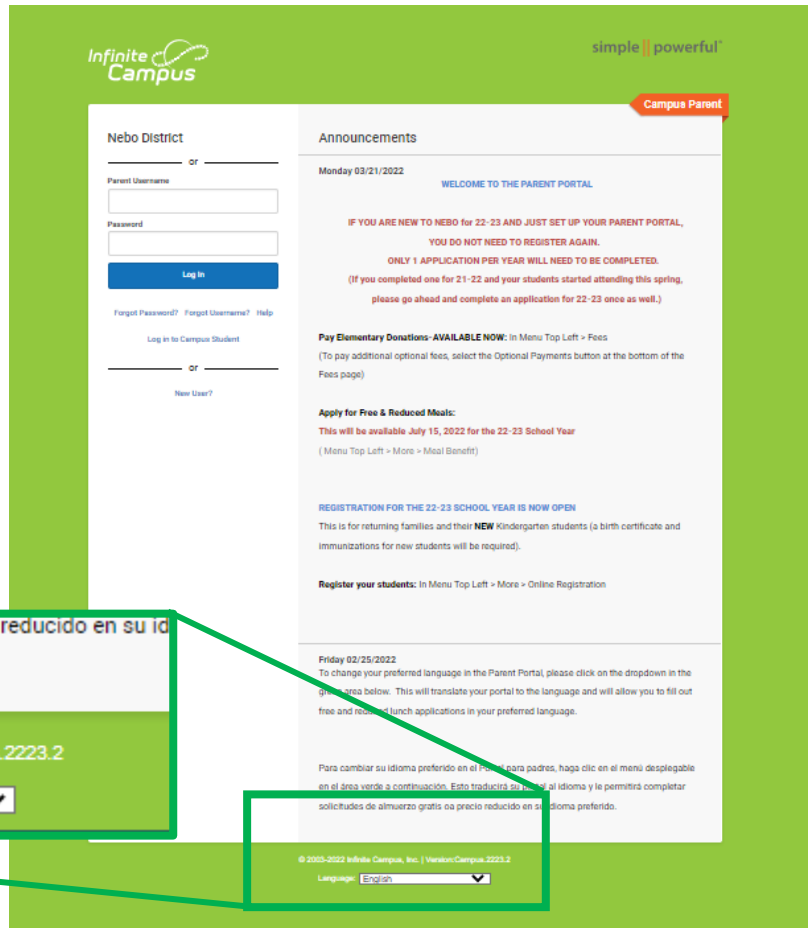

****to change the language of your portal to English or Spanish **Once logged in:** - From the user menu, click **Language** to change the language that Campus Parent displays in.**

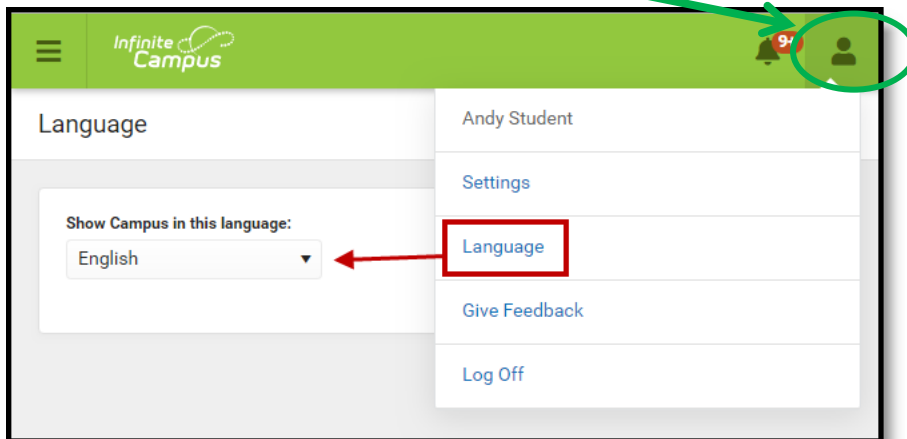

At the main screen, if you do not see the menu (black on left), select the “hamburger” or “three bars” icon.

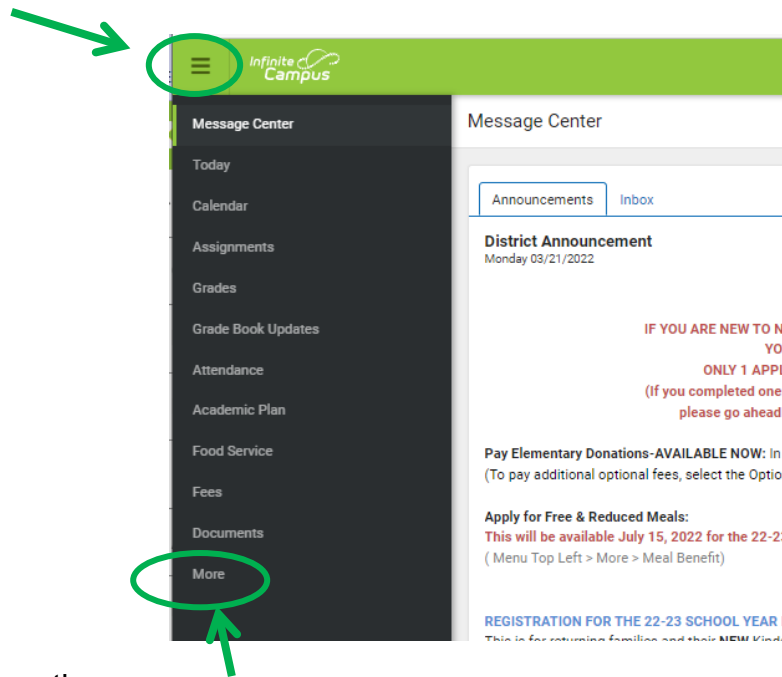

Select **More** from the menu

From the **More** menu, select **Meal Benefits**

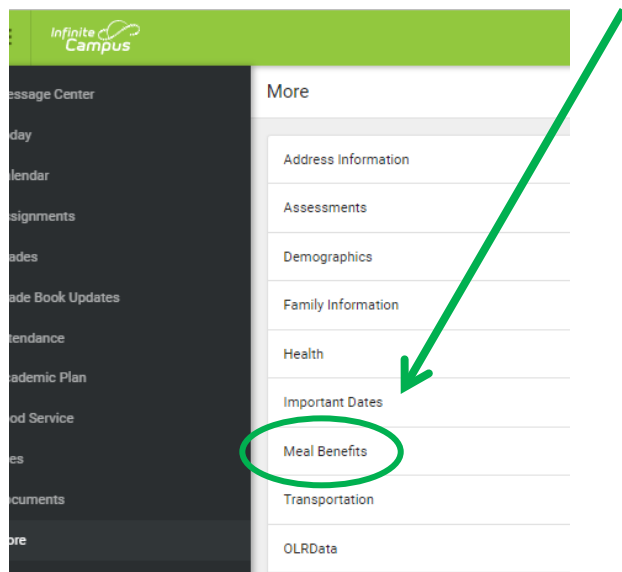

Click to start the application process

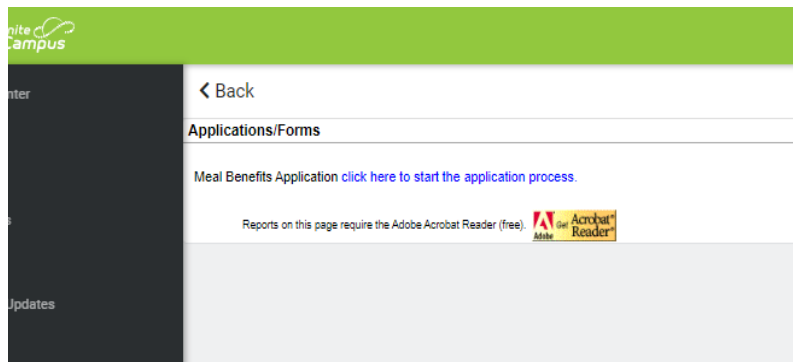

If you do not already have an E-Signature PIN setup, you will be asked to setup the pin. You will use this pin to e-sign and submit the application. Select YES to create your pin.

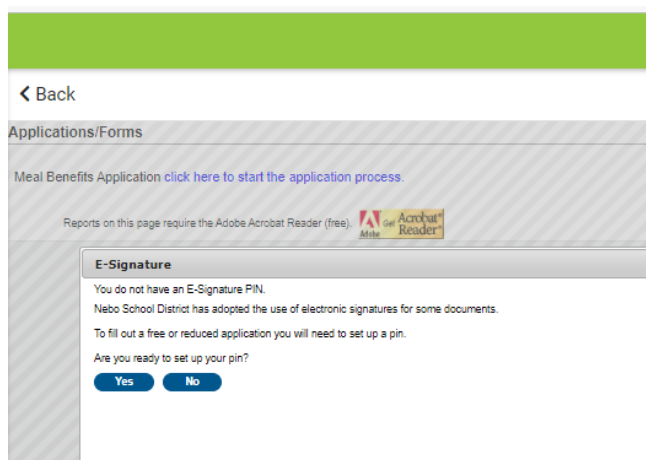

Create your PIN:

- Enter five (5) letters, numbers or special characters (!@#\$%^&*+?~|=).
- You must have at least one (1) of each of two (2) of the types.

Re-enter PIN

Password:

*this is your Parent Portal Password.

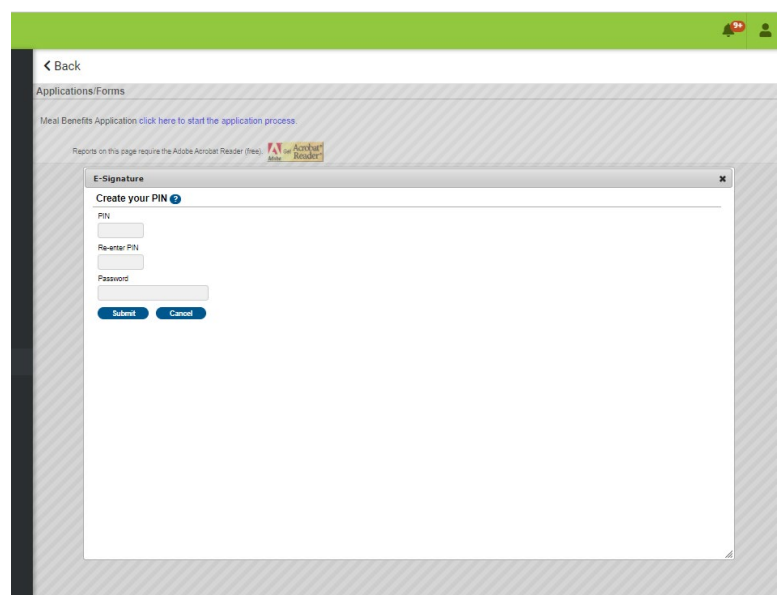

This screenshot shows the 'Letter to Household' step of the Meal Benefits Application. At the top, a progress bar indicates the current step is 'Letter to Household', with other steps including Instructions, Signer Confirmation, Household Members, Children, Gross Income, Review, Authorization, and Submitted. Below the progress bar, a message states: 'Letter to Household contains important information you will need during the application process. You may print a PDF of this letter by selecting the print icon. Select 'Next' to continue or 'Quit' to stop.' A PDF viewer is embedded in the page, displaying the document's title 'Letter to Household' and the beginning of the letter: 'Dear Parent/Guardian: Children need healthy meals to learn. Nebo School District offers healthy meals every school day. Breakfast and lunch meals are FREE for the 2021/22 school year. This packet includes an application for free or reduced price meal benefits, and a set of detailed instructions. Below are some common questions and answers to help you with the application process.' The first question visible is '1. WHO CAN GET FREE OR REDUCED PRICE MEALS?'. At the bottom of the PDF viewer, there are 'Quit' and 'Next' buttons, and a 'Timeout 59:49' indicator.

This screenshot shows the 'Application Instructions' step of the Meal Benefits Application. The progress bar at the top highlights 'Application Instructions' as the current step. A message reads: 'Application Instructions will help guide you through the application process. You may print a PDF of this letter by selecting the print icon. Select 'Next' to continue.' The PDF viewer displays the document title 'How To Apply For Free And Reduced Priced Student Meals' and provides detailed instructions for the application process, including information about electronic signatures and signer confirmation. At the bottom of the PDF viewer, there are 'Previous' and 'Next' buttons, and a 'Timeout 59:56' indicator.